

## Property Details:

- 2+ Acre Luxury Estate Lots
- Gated Community
- Big Hilltop Views
- Creek front Lots
- Parker County
- Any Custom Builder
- **No Water Bills, No City Taxes**
- **Aledo ISD**

## For More Information:

(817) 865-3377

[thebearcreekranch.com](http://thebearcreekranch.com)

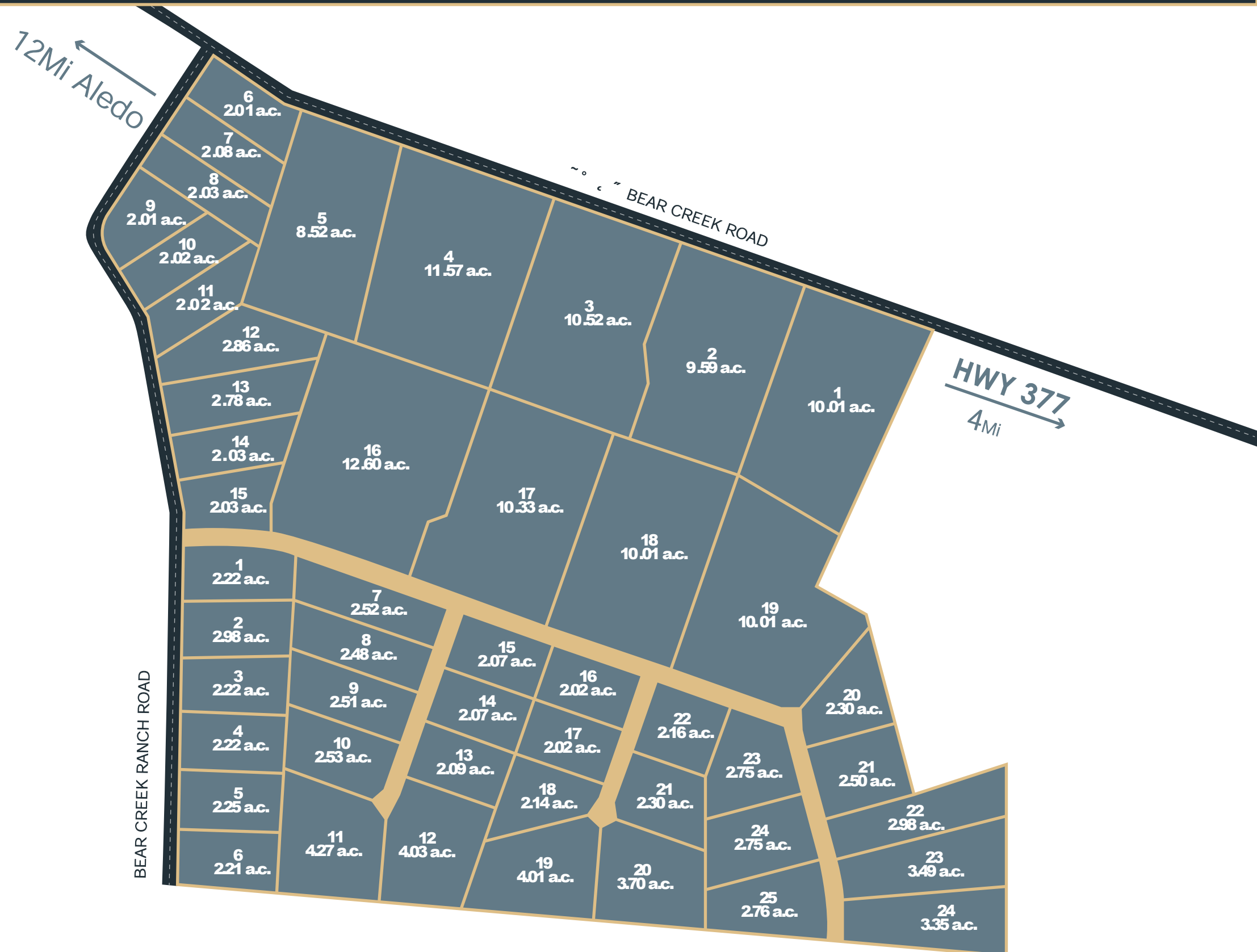

All lots require private water wells and septic systems. The layout of these properties and all future areas are subject to change.